

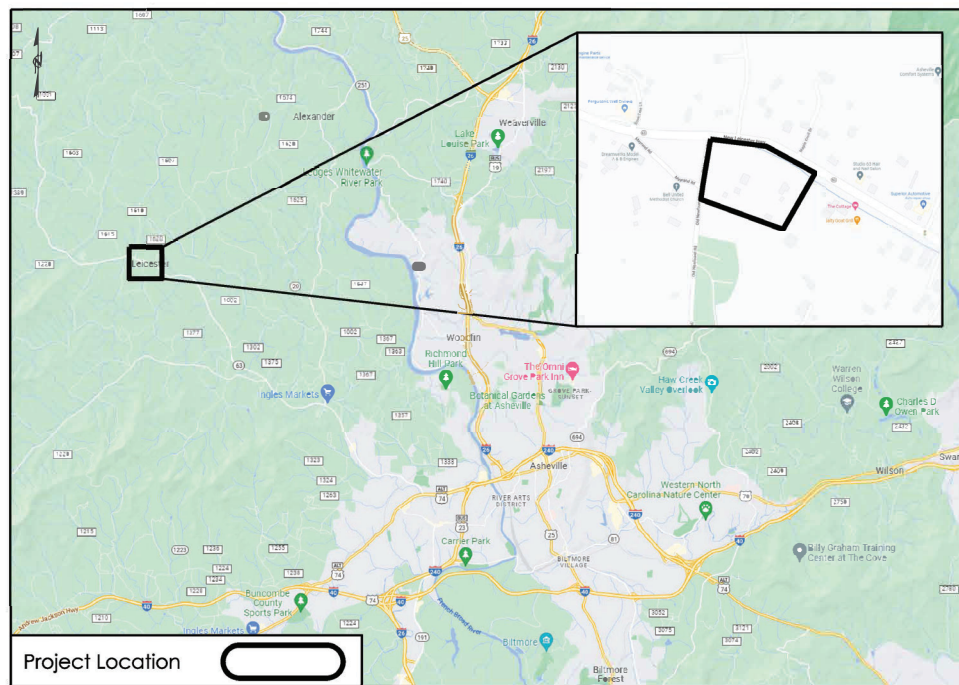

HIGHWAY LANDSCAPE DEVELOPMENT PROJECT



T.I.P. #	STATE PROJECT W.B.S. #	SHEET #	SHEET # TOTAL
U-3301	-----	L1	3
FED. PROJ. #	DESCRIPTION		DIVISION
-----	TIP		13



Summary of Quantities
3 Year Establishment

DES	SEC	QTY	UNIT	KEY	BOTANICAL NAME	COMMON NAME	FURNISH	NOTES	A.S.N.S.
Trees									
L	1670	9	ea	AR	<i>Acer rubrum</i> "Franksred"	Red Sunset Maple	2.5-3" Cal.; B&B	16' O.C.	2.1
L	1670	4	ea	CD	<i>Cedrus deodara</i>	Deodar Cedar	8-10"; B&B	As Shown	4.7
L	1670	6	ea	CC	<i>Cercis canadensis</i>	Eastern Redbud	6-7"; B&B	As Shown	2.3
L	1670	3	ea	FG	<i>Fagus grandifolia</i>	American Beech	2-3" Cal.; B&B	As Shown	2.2
L	1670	4	ea	JN	<i>Juglans nigra</i>	Black Walnut	2-3" Cal.; B&B	As Shown	2.2
L	1670	7	ea	OA	<i>Oxydendrum arboreum</i>	Sourwood	7-8"; B&B	As Shown	2.3
L	1670	14	ea	PS	<i>Pinus strobus</i>	Eastern White Pine	8-10"; B&B	As Shown	4.7
L	1670	13	ea	TS	<i>Thuja standishii</i> x <i>plicata</i> "Green Giant"	Green Giant Arborvitae	7-8"; B&B	As Shown	4.7
L	1670	16	ea	TC	<i>Tsuga caroliniana</i>	Carolina Hemlock	8-9"; B&B	As Shown	4.7
Shrubs									
L	1670	26	ea	EA	<i>Euonymus alatus</i> "Compactus"	Dwarf Burning Bush	18-24"; #3 Cont.	6' O.C.	3.3
Other Vegetation Costs									
L	1670	36	ea		Monthly Establishment				
L	1670	99	cy		Mulch for Planting (Year 1)			Depth of 4"	
L	1670	50	cy		Mulch for Planting (Year 2)			Depth of 2"	
L	1670	50	cy		Mulch for Planting (Year 3)			Depth of 2"	
L	1670	902	sy		Pre emergence Herbicidal Treatment				
L	1670	902	sy		Post emergence Herbicidal Treatment				
L	1651	2	ea		Selective Tree Removal (6")				
L	SP	6	ea		Selective Tree Transplanting				
L	1651	0.3	acre		Selective Undergrowth Removal				
L	SP	6	cy		Topsail				
L	SP	454	LF		Tree Protection Fence				
L	1670	18	m/g		Water for Planting				
[] - Alternative Plant Option									
m/g - 1,000 gallons									

CONVENTIONAL SYMBOLS

County Line.....	-----
City or Town Line.....	-----
Exist. Right of Way Line Marker.....	-----▲-----
Prop. Right of Way Line Marker (By Others).....	-----▲-----
Prop Right of Way Line Marker (By Contract).....	-----▲-----
Exist. Control of Access Line.....	-----○-----
Prop. Control of Access Line.....	-----○-----
Property Line.....	-----
Easement Line.....	-----
Slope Stake Line.....	-----
Exist. Fence.....	-----
Prop. Woven Wire Fence.....	-----
Prop. Chain Link Fence.....	-----
Exist. Road.....	-----
Prop. Road.....	-----
Guardrail.....	-----
Survey Line.....	-----
Denotes Line Equality.....	-----
Bridge.....	-----
Culvert.....	-----
Railroad.....	-----
Woods.....	-----
Exist. Telephone Pole.....	-----
Prop. Telephone Pole.....	-----
Tower Pole and Line.....	-----
Exist. Power Pole.....	-----
Prop. Power Pole.....	-----
Sanitary Sewer Line.....	-----
Water Line.....	-----
Gas Line.....	-----
Picnic Shelter.....	-----
Regeneration.....	-----
Reforestation.....	-----

INDEX OF L SHEETS:

L 1.0 - Title Sheet
L 2.0 - Planting Details
L 3.0 - Planting Plans

PREPARED BY: B. Kopetsky **DATE:** 2/7/2017
K. Cooper 1/27/2023

REVISIONS

DATE	DESCRIPTION

U-3301 Hughes House Historic Mitigation Landscape

NOTES:

- Existing conditions shown on the plans are based on survey information and roadway plans. actual site conditions may vary.
- Prior to any demolition or work taking place, the contractor shall locate and verify all utility lines and structures within the construction areas (water, sewer, gas, electrical, etc.)
- The contractor shall take the necessary precautions to prevent damage of adjacent plant material, facilities, and structures to remain. The contractor shall restore disturbed areas to their original condition and to the satisfaction of the Division Roadside Environmental Engineer.
- The utilities shown on the plans are approximate locations. The contractor shall locate and protect in place all existing utilities before digging occurs and major construction begins.
- Demolition, removal, and disposal of items from the site must be completely in accordance with the law. The contractor is responsible for making a site visit to determine and verify all demolition requirements prior to bidding.
- The contractor shall verify all conditions and dimensions at the job site prior to construction, and if discrepancies are found, notify the Division Roadside Environmental Engineer for clarification.



**STATE OF
NORTH CAROLINA
DEPARTMENT OF TRANSPORTATION**







LOCATION: Leicester Highway (NC 63)

TYPE of WORK: TIP

COUNTY: Buncombe

2014 American Standard for Nursery Stock
2018 NCDOT STANDARD SPECIFICATIONS
PREPARED IN THE OFFICE OF:
NCDOT- ROADSIDE ENVIRONMENTAL UNIT
AESTHETIC ENGINEERING SECTION
1557 MAIL SERVICE CENTER
RALEIGH, NC 27699 919-707-2920

NOTES:

-  Plant hole width (x) to be twice the root ball size or container diameter.
-  See standard specifications for plant bed herbicidal treatment.
-  Apply fertilizer at time of planting in the form of a slow release pellet or tablet. Apply at rate recommended by manufacturer. Both rate and formulation must be approved by field engineer prior to application.
-  Remove top 1/3 of wire basket and fold burlap back from top of root ball before backfilling is complete.
-  All pruning to follow standard arboricultural practices as specified by international society of arboriculture.
-  Do not attempt to straighten a tree that has been planted at an angle with the use of staking or guying. Remove the tree and replant to an upright position.

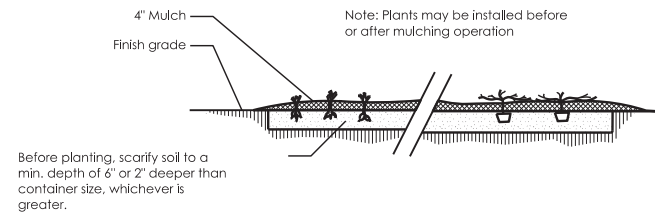

1 Ground Cover/ Bedding Plant Detail
NTS

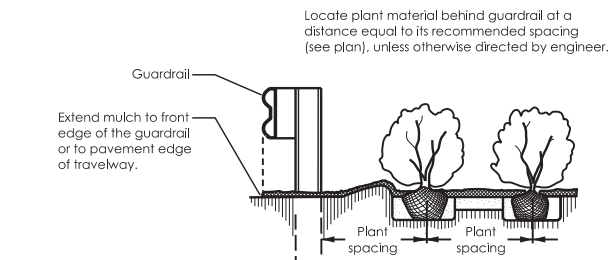

2 Guardrail Mulching Detail
NTS

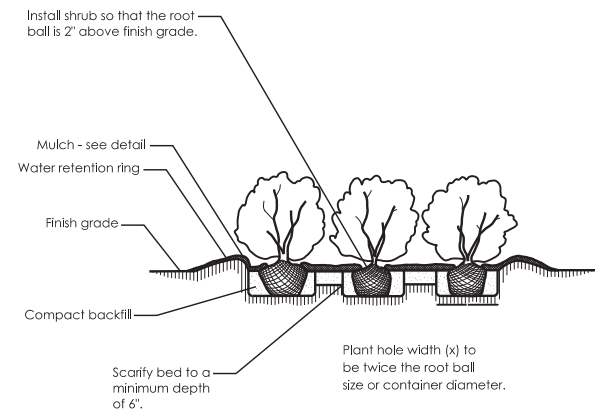

3 Shrub Bed Planting Detail
NTS

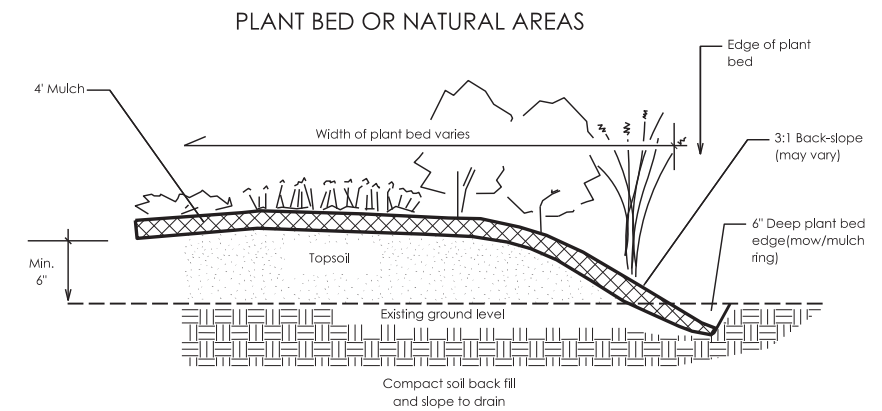

4 Plant Bed Edge Detail
NTS

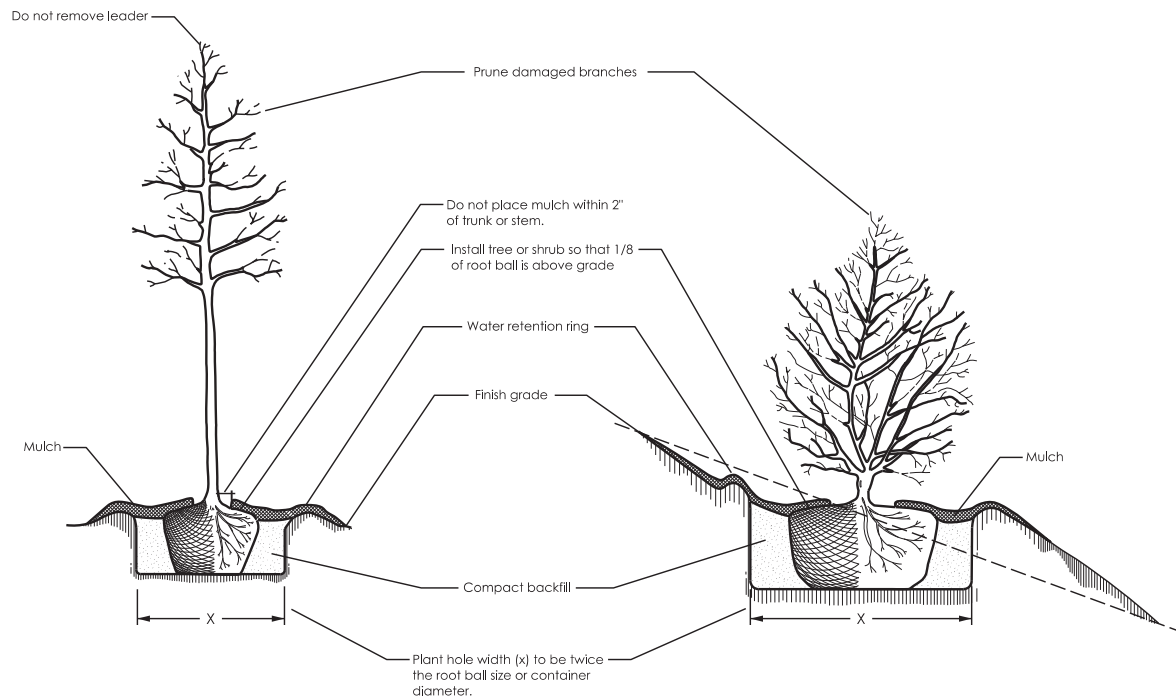

5 Tree Or Shrub Planting Detail
NTS

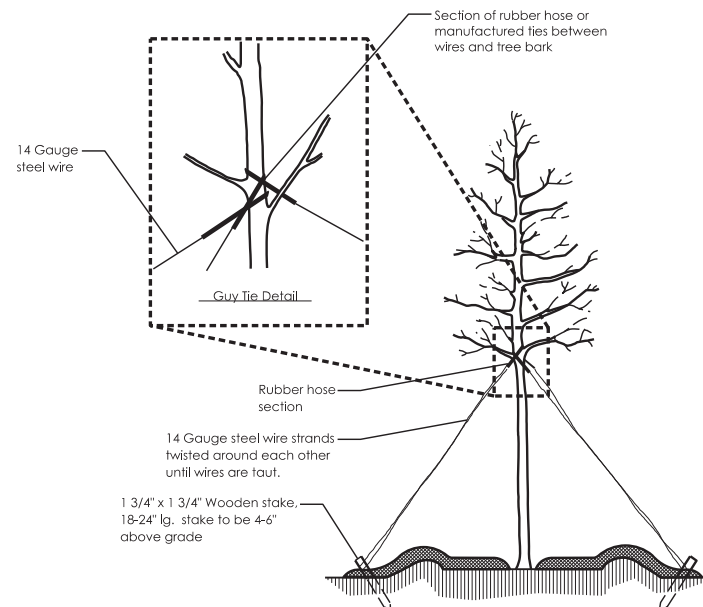

6 Tree Guying Detail
NTS

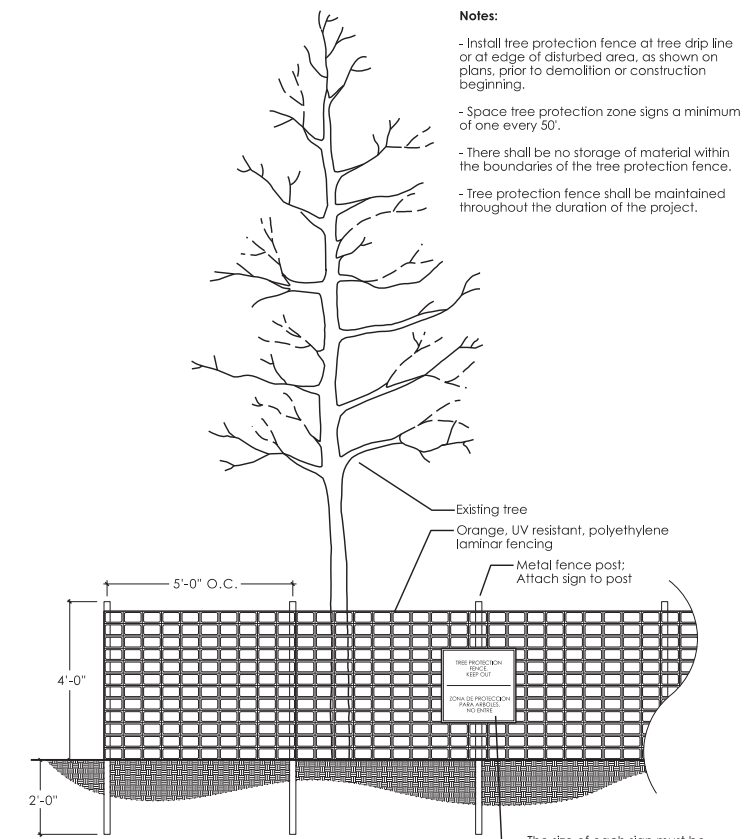

7 Tree Protection Fence
NTS

- Notes:**
- Install tree protection fence at tree drip line or at edge of disturbed area, as shown on plans, prior to demolition or construction beginning.
 - Space tree protection zone signs a minimum of one every 50'.
 - There shall be no storage of material within the boundaries of the tree protection fence.
 - Tree protection fence shall be maintained throughout the duration of the project.



NCDOT - ROADSIDE ENVIRONMENTAL UNIT
AESTHETIC ENGINEERING SECTION
1557 MAIL SERVICE CENTER RALEIGH NC 27699-1557
PH: 919-707-2935 FAX: 919-715-2554
http://www.ncdot.org/doh/operations/dp_chief_eng/roadside/

Hughes House Historic Mitigation Landscape
Buncombe County
TIP #: U-3301

SHEET DESCRIPTION:	PREL. DESIGN DATE:	2/7/2017
	FINAL DESIGN DATE:	1/27/2023
	PROJECT LANDSCAPE ARCHITECT:	Bob Kopetsky, PLA (retired) Kyle Cooper, PLA

Planting Details
Landscape Plan Sheet



T.I.P. #	U-3301
WBS #	-----
FED I.D. #	-----
SHEET NO.:	L-2
TOTAL SHEET NO.:	L-3

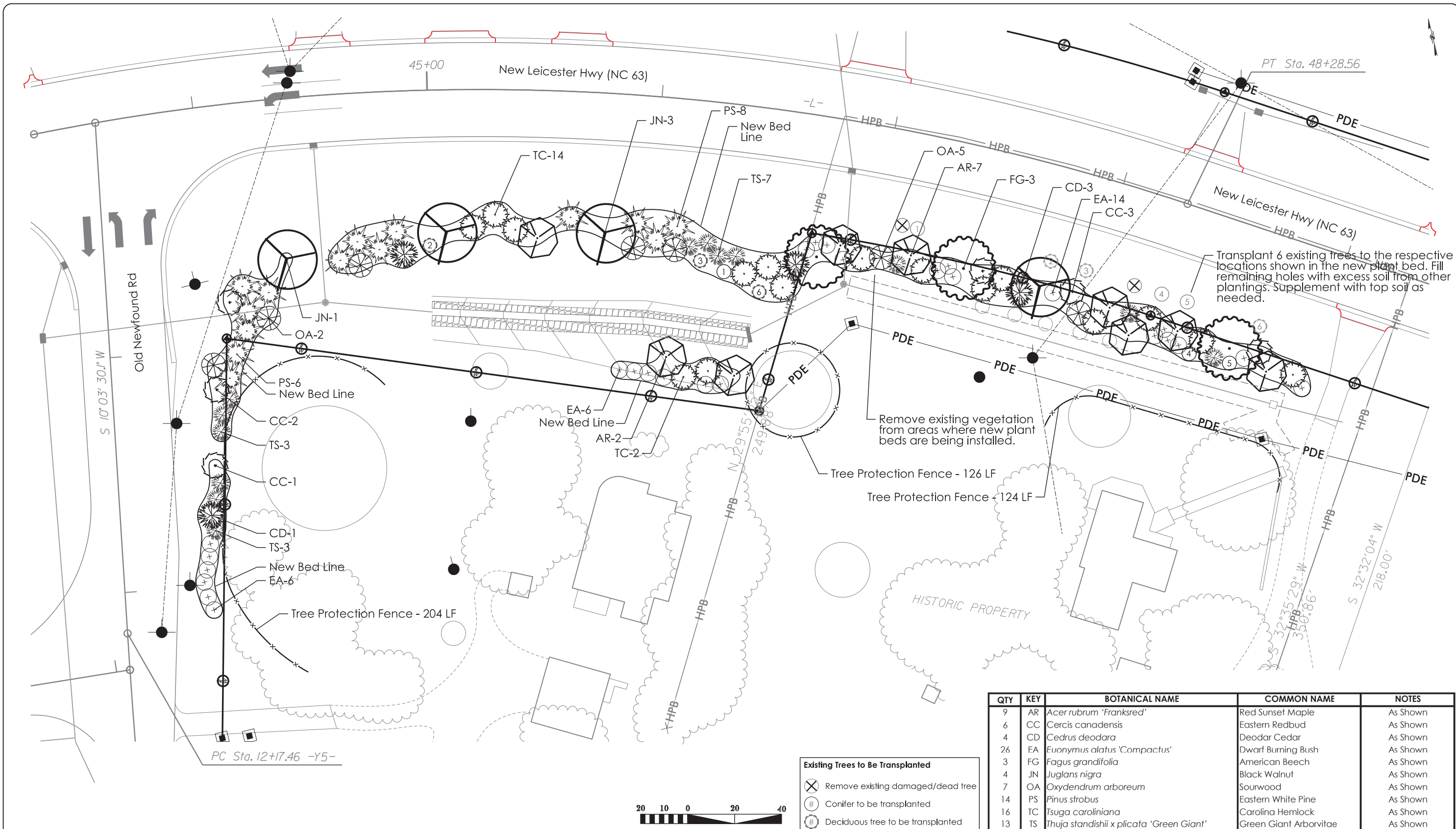

Transplant 6 existing trees to the respective locations shown in the new plant bed. Fill remaining holes with excess soil from other plantings. Supplement with top soil as needed.

Remove existing vegetation from areas where new plant beds are being installed.

Tree Protection Fence - 126 LF
Tree Protection Fence - 124 LF

Tree Protection Fence - 204 LF

QTY	KEY	BOTANICAL NAME	COMMON NAME	NOTES
9	AR	<i>Acer rubrum</i> 'Franksred'	Red Sunset Maple	As Shown
6	CC	<i>Cercis canadensis</i>	Eastern Redbud	As Shown
4	CD	<i>Cedrus deodara</i>	Deodar Cedar	As Shown
26	EA	<i>Euonymus alatus</i> 'Compactus'	Dwarf Burning Bush	As Shown
3	FG	<i>Fagus grandifolia</i>	American Beech	As Shown
4	JN	<i>Juglans nigra</i>	Black Walnut	As Shown
7	OA	<i>Oxydendrum arboreum</i>	Sourwood	As Shown
14	PS	<i>Pinus strobus</i>	Eastern White Pine	As Shown
16	TC	<i>Tsuga caroliniana</i>	Carolina Hemlock	As Shown
13	TS	<i>Thuja standishii</i> x <i>plicata</i> 'Green Giant'	Green Giant Arborvitae	As Shown

- Existing Trees to Be Transplanted**
- ⊗ Remove existing damaged/dead tree
 - ⊕ Conifer to be transplanted
 - ⊖ Deciduous tree to be transplanted

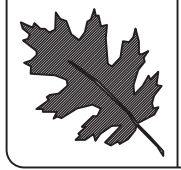

NCDOT - ROADSIDE ENVIRONMENTAL UNIT
AESTHETIC ENGINEERING SECTION
1557 MAIL SERVICE CENTER RALEIGH NC 27699-1557
PH: 919-707-2935 FAX: 919-715-2554
http://www.ncdot.org/doh/operations/dp_chief_eng/roadside/

Hughes House Historic Mitigation Landscape
Buncombe County
TIP #: U-3301

PREL. DESIGN DATE: 2/7/2017
FINAL DESIGN DATE: 1/27/2023
PROJECT LANDSCAPE ARCHITECT: Bob Kopetsky, PLA (retired) Kyle Cooper, PLA

Planting Plan
Landscape Plan Sheet

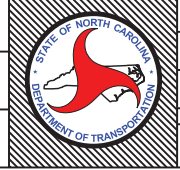

T.I.P. # U-3301
WBS # - - - -
FED I.D. # - - - -
SHEET NO.: L-3 TOTAL SHEET NO.: L-3